

Simple to use

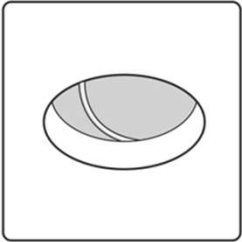

Make sure all wires are safely recessed into the downlight hole

Make sure any electric cables are not live before fitting

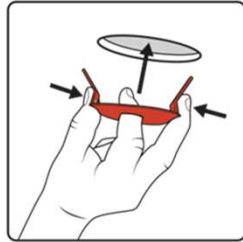

With one hand squeeze the wings in slightly and then insert into the hole

Check that the protector is flush against the ceiling before plastering



Plaster over the downlight protector with a skim of 2 to 3 mm

A hole may be left in the middle of the protector. This is normal

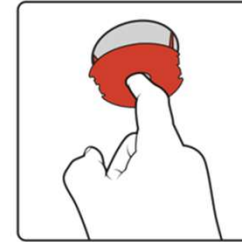

Put a finger into the central hole and pull down after the final trowel

Pull the protector out slowly without twisting or damaging the plaster

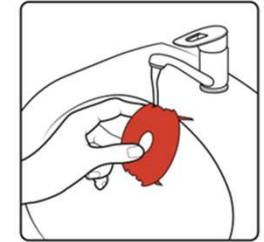

To reuse Stoplas Protectors, wash in clean water after use

The product should be recycled as PP



STOPLAS
UK patent pending
Saves Time & Money
Fits in seconds

Your go-to solution for downlight plastering

Plaster straight over the hole as if it were plasterboard saving time and delivering an excellent finish
Insert stops plaster from fouling holes eliminating rework saving you time and money
Fitted and removed in seconds forming a barrier to protect cables from damage



SCAN ME FOR INSTRUCTIONS